



Rumble Tuff®

Mighty Tyke

Electric Breast Pump Duo



Instructions & Assembly

Table of Contents

Important Safeguards	4
Danger	4
Caution	4
Warning	5
Accessories and Parts	6
Included Accessories	6
Expression Collection Combo Kit	6
About Your Mighty Tyke Duo	7
Expression Indicator Lights	7
Electric Breast Pump Main Unit	7
Bottle Assembly	8
How to Assemble the Expression Collection Combo Kit	8
Power Options	13
9V AC/DC Power Adapter	13
Built-in Li-Ion Rechargeable Battery	13
Getting Started	14
How to Use Your Rumble Tuff® Electric Breast Pump Duo	14
LED Light Sign Guide	15
Silent/Sound Mode	16
Cleaning Instructions	17
Sanitize Prior to First Use	17
Before Each Use	17
General Cleaning Instructions	17
Tubing Cleaning Instructions	18
Drying Bag	18

Troubleshooting	19
Interruption of Electrical Service	19
Radio Frequency Energy	19
Decreased Suction	19
Pump Doesn't Start	20
Low Battery	20
Breastmilk Buildup In the Breastshield Body	20
Where to get Replacement Parts	20
Technical Data	21
Power Requirements	21
Technical Specifications	21
Key to Box Symbols	21
Warranty	22

Important Safeguards

The Rumble Tuff® Electric Breast Pump is designed for a single user and should never be shared or resold; doing so will void the warranty.

READ ALL INSTRUCTIONS BEFORE USING

DANGER:

To reduce the risk of electrocution:

- Always unplug this product immediately after using.
- Do not use while bathing.
- Do not place or store this product where it can fall or be pulled into a tub or sink.
- Do not place or drop into water or other liquid.
- Do not reach for an electrical product that has fallen into water. Unplug immediately.
- Children should be supervised to ensure that they do not play with the appliance.
- Do not allow children or pets to play with motor unit, the adapter or accessories, as these parts may pose a choking or strangulation hazard.

CAUTION:

- Do not use this product for any other purpose than as indicated in the manual.
- Make sure all the parts are assembled correctly before operating.
- Stop using the breast pump immediately if your breasts or nipples experience pain or discomfort.
- Please wash hands before using this product.
- Keep this product out of reach of babies and children.
- Do not drop or hit the product. Doing so may cause damage not covered by the warranty.
- Do not touch the product with bare hands right after sterilizing by boiling water to avoid scalds and burns.
- Do not over-boil to avoid premature aging of the product materials.
- Do not use accessories, detachable parts, and materials not described in the instructions.
- Do not connect the pump or any of its accessories to any other equipment not described in the instructions.

WARNING:

To reduce the risk of burns, electrocution, fire, or injury to persons:

- This product should never be left unattended while plugged in.
- Close supervision is necessary when this product is used near children or invalids.
- Use this product only for its intended use as described in this manual. Do not use attachments not recommended by Rumble Tuff.
- Do not operate this product if it has a damaged cord or plug, if it is not working properly, if it has been dropped or damaged, or if it has been dropped in water.
- Keep the cord away from heated surfaces.
- Do not use while sleeping or drowsy.
- Do not drop or insert any other object into any opening or tubing.
- Do not operate outdoors with the AC/DC Adaptor, where aerosol spray products are being used, or where oxygen is being administered.
- Make sure the voltage of the AC/DC Adaptor is compatible with the power source.
- Plug the AC/DC Adaptor into the electrical outlet first, then plug the Power Cord into your Rumble Tuff® Electric Breast Pump Duo.
- Rumble Tuff has provided an AC/DC Adaptor and a built-in Li-ion Battery with this device. Use of any AC/DC adapter or Li-ion battery not approved by the manufacturer will void the warranty.
- If you are infected with Hepatitis A, Hepatitis B, or have HIV (Human Immunodeficiency Virus), pumping breast milk does not reduce or remove the risk of transmitting the virus to your baby through breast milk.
- Wash the Expression Collection Combo Kit parts before each use.
- Do not operate a motor vehicle while using the Rumble Tuff® Electric Breast Pump Duo.
- Do not attempt to modify the product.

SAVE THESE INSTRUCTIONS

along with your receipt for future reference.

Accessories and Parts

Included Accessories



Breast Pump
Main Unit

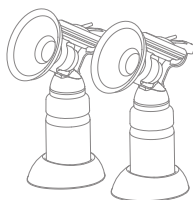

Expression
Collection
Combo Kits
(2 Sets)



Vacuum Tubing with
Adaptor

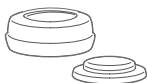

Bottle Adaptor Kits
(2 Sets)

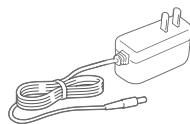

AC/DC Adaptor

* Included accessories may vary by country and may change without notice.

Expression Collection Combo Kit

Electric Diaphragm Kit

Cap

Diaphragm

Cup with O-Ring

Expression Collection Kit

Breastshield Body

Silicone Cushion

One-Way Valve

Bottle Adapter

Collection Bottle

Bottle Base

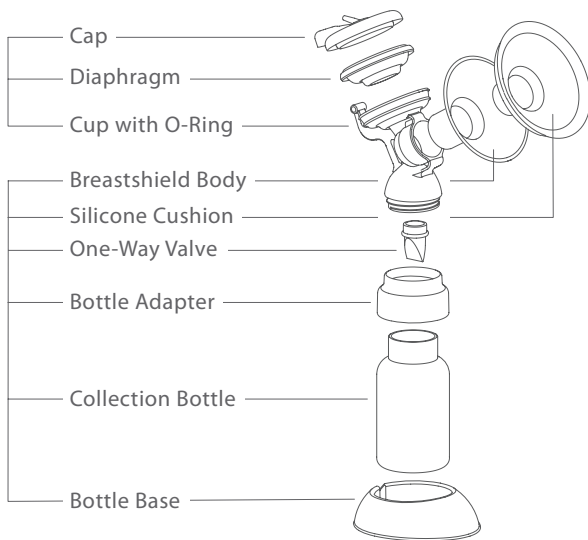

Electric Breast Pump Main Unit

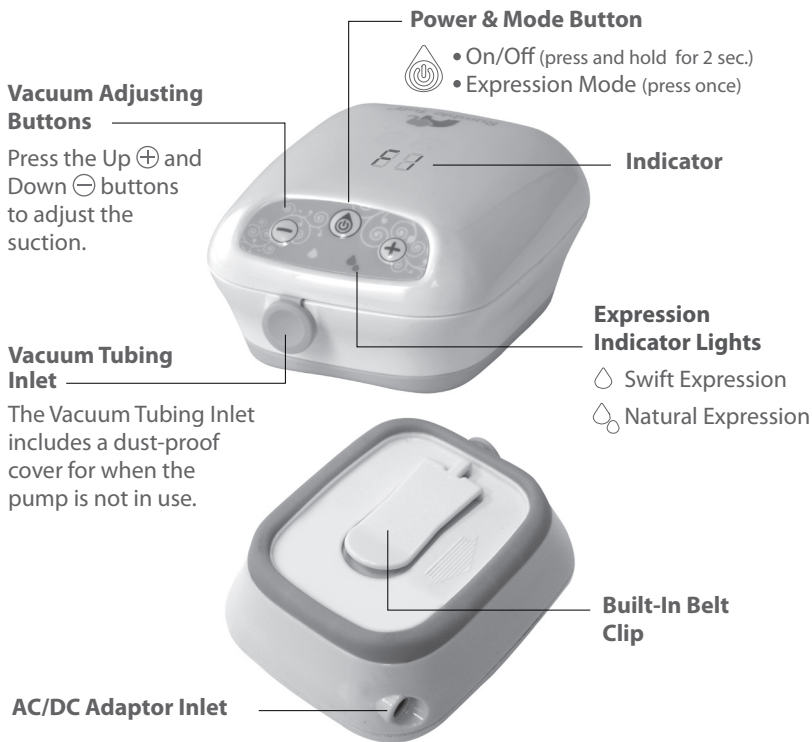

Expression Indicator Lights



White LED light.

Swift Expression helps stimulate milk flow.

This is a fast, shallow suction pattern. When a baby has just latched on, the nursing pattern is fast and shallow to start the mother's milk flow.



Blue LED light.

Natural Expression helps to express milk.

This is a longer, deeper suction pattern. When the mother's milk begins to flow (letdown), the baby often changes to a longer, deeper suction pattern.

Bottle Assembly

How to Assemble the Expression Collection Kit



Hold the neck in one hand and make sure the bottle-thread side opening is facing up.



Insert the One-Way Valve onto the bottom of the neck of the Breastshield Body.

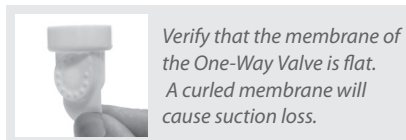

Confirm that the One-Way Valve is securely installed.

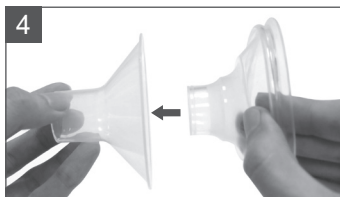

If desired, place the Silicone Cushion into the Breastshield.

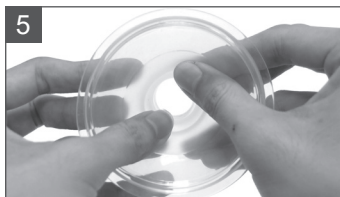

Push the center of Silicone Cushion into the bottom.

How to Assemble the Expression Collection Kit

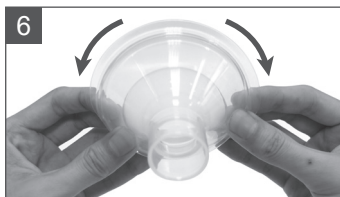

Secure the lip of the Cushion around the edge of the horn.



Ensure the lip of the Cushion is securely in place.

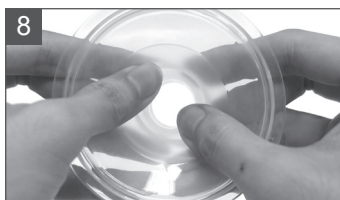

Push the center of Silicone Cushion into the bottom again to release any extra air.

Note: Your Electric Breast Pump will work with or without the Silicone Cushion. Your comfort depends on your preference.

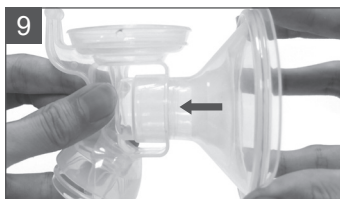

Insert the Breastshield into the neck.

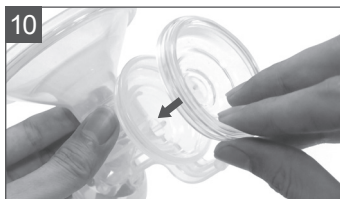

Place the Diaphragm in the Cup.

Note: Do not reverse the order of steps 10 through 15. Doing so will cause suction loss when pumping.

Bottle Assembly

How to Assemble the Expression Collection Kit

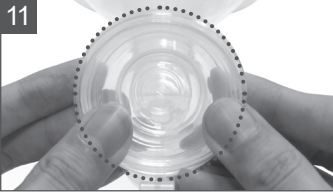

Press around the edges of the Diaphragm for a secure fit.



Ensure that the Diaphragm is securely seated in place. This is crucial to achieving proper suction and preventing the backflow of milk.



Place the Cap on the Cup and Diaphragm.

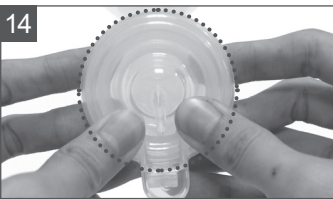

Be sure to align the hinge and hinge cover. Press tightly to seal.



The Electric Diaphragm Kit is assembled.

How to Assemble the Expression Collection Kit

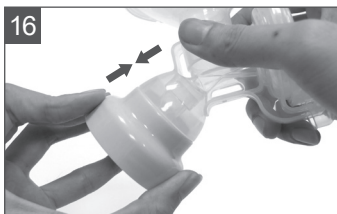

Twist the Bottle Adaptor onto the Breastshield Body.



Twist on the Collection Bottle for a secure fit.

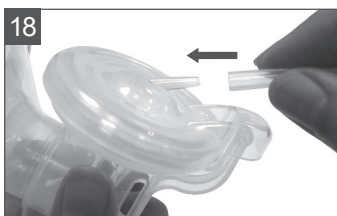

Connect the tubing to the Tubing Connector located on the Cap.

Note: Make sure that there is no moisture in the tubing.

To Use As a Single Pump:

Remove one tube and close the cap.

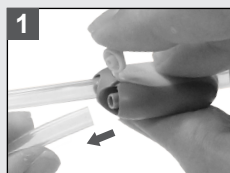

Pull out one single silicone tube.

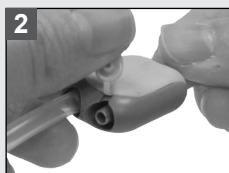

Seal the opening.



Ready to use as a single pump.

How to Assemble the Expression Collection Kit



Push together firmly for a tight seal.



The Expression Collection Combo Kit is assembled.



Make sure the Tubing Adaptor is properly inserted into the Tubing Adaptor Inlet on the Electric Pump Main Unit.

Your Electric Breast Pump may be operated under any of the following power supply modes:

9V AC/DC Power Adapter

Electrical safety can only be achieved when using the AC/DC Adapter provided with the Pump. Use of any another adapter poses a risk to the safety of the product and/or the user and may void the warranty.



Plug the AC/DC Adapter into an electrical outlet.

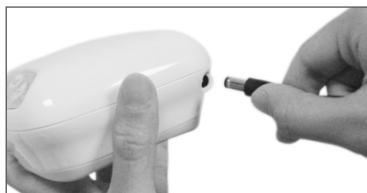

Attach the power cord to the breast pump.

Built-in Li-Ion Rechargeable Battery

- Prior to first use, charge the battery for 12 hours. If necessary, your Electric Breast Pump can be used during this period with the Power Cord only. For best results, allow the battery to initially charge uninterrupted for 12 hours.
- After the initial charge, subsequent charges will take approximately 4 hours.
- The Li-Ion Rechargeable Battery will charge every time the AC/DC Adapter is plugged in; however, it will not charge while your Electric Breast Pump is in use.
- The Swift Expression LED and Natural Expression LED lights will flash alternately while the battery is charging.

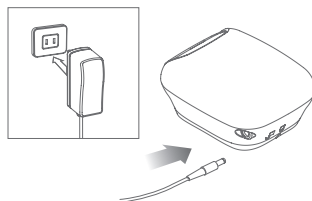

Note: *The Li-Ion Rechargeable Battery used in this device may present a risk of fire or chemical burn if mistreated. Do NOT disassemble the battery. Do NOT place battery near a heat source or fire. Dispose of used battery properly. Do NOT dispose of battery in fire. For long-term storage, keep battery within the following temperature range: 32°F to 77°F (0°C to 25°C). Keep away from children.*

Getting Started

How to Use Your Rumble Tuff® Electric Breast Pump Duo

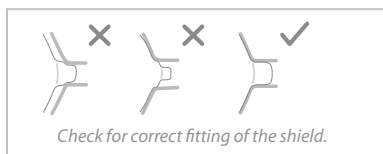



Hold the Expression Collection Combo Kits to your breasts so that your nipples are centered in the Breastshield.





Press and hold the Power/Mode Button  until the pump starts.

Hold the button long enough (approximately 2 seconds) for the pump to start.

The pump will start in the Swift Expression mode  at the last suction level used. The Swift Expression LED will light up. You can change the expression setting at any time by pressing the Power/Mode button. 

Switch to the Natural Expression Mode , once you achieve letdown. It will start in the last suction level used.















While pumping, use the Vacuum Adjusting Buttons  and  to adjust the suction level.



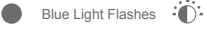

Press and hold the Power/Mode button for more than 2 seconds to turn the pump off. If the pump is left on but attended for more the 30 minutes, it will automatically shut off.

Note: Make sure there is no suction on the nipple before removing the Breastshield. If necessary, break the suction by inserting a finger between the Breastshield and the breast, similar to the way you break away from your baby's suction.



While Pump is On		
State	Signal	Indicator
Pumping in Swift Expression	Swift Expression LED (White Light) (White Light) (Blue Light)  White Light is On 	Swift Expression LED (1 - 8) 88 82 83 84 85 86 87 88
Pumping in Natural Expression	Natural Expression LED (Blue Light)  Blue Light is On 	Natural Expression LED (F1 - F9) F8 F2 F3 F4 F5 F6 F7 F8 F9
Battery is Low (Swift Expression Mode)	 White Light Flashes 	88 (1)
Battery is Low (Natural Expression Mode)	 Blue Light Flashes	88 (F1)
Battery is Dead	 Both Blue & White Lights Flash, then turn Off	88 (Lo)
Sound is Muted / Sound is On (While Pump is Off)	 White Light Flashes   Blue Light Flashes	88 / 88 (SL / bb)
While Pump is Off		
State	Signal	Indicator
Battery is Charging	 Blue & White Lights Flash Alternately	88 (CH)
Charging is Complete	 Both Blue & White Lights are On	88 (FL)

 Light Is Off
  Light Is On
  Light Is Flashing

Silent/Sound Mode

Silent/Sound Mode:

The Silent/Sound Mode can only be changed while in the Off State.

To change to Silent Mode, press ⊕ and ⊖ at the same time for 3 seconds. Both the Swift Expression LED and the Indicator (with "SL" display) will flash three times. When the device is on Silent Mode, all sounds are turned off except for the Forced Shutdown Sound.

To change to Sound Mode, press ⊕ and ⊖ at the same time for 3 seconds. Both the Natural Expression LED and the Indicator (with "bb" display) will flash three times. When the device is on Sound Mode, all default sounds are turned on.

Sanitize Prior to First Use:

Before you use your Rumble Tuff® Electric Breast Pump Duo for the first time, disassemble and boil all parts of the Expression Collection Combo Kit in water for 10 minutes.

- Be sure to use enough water to keep all parts afloat while boiling.
- **Do NOT boil Tubing or Tubing Adapter.**
- Remove all parts from the water immediately after sterilizing. To avoid scalds and burns, do NOT touch the product with bare hands right after sterilizing.
- Completely air-dry or towel-dry before reassembling.

Partially dry components may affect the operation of your Electric Breast Pump Duo. Please ensure that all parts are completely dry before use.

Before Each Use:

- Wash your hands thoroughly with soap and warm water before handling the Expression Collection Combo Kit, the Electric Breast Pump, or any Expression Collection parts or attachments.
- Make sure all parts are clean and dry.
- Ensure the Tubing is free from any liquid. **Do NOT operate your Rumble Tuff® Electric Breast Pump Duo if any liquid is visible in the Tubing.** (See Tubing Cleaning Instructions on page 18.)

General Cleaning Instructions:

- **Caution:** Take care when cleaning the One-Way Valve. If it gets damaged, your breast pump will not function properly. To clean the One-Way Valve, rub it gently between your fingers in warm, soapy water, then rinse thoroughly in clean, warm water. Do not insert any objects into the One-Way Valve as this may damage the valve.
- Set aside the Tubing. Under the normal working conditions of the pump, the Diaphragm prevents the backflow of milk. Therefore, these items do not need to be washed. If any liquid or liquid vapor is found inside the Tubing, follow the Tubing Cleaning Instructions (page 18) carefully before use.



Cleaning Instructions

- All parts of the Expression Collection Combo Kit may be cleaned in the upper compartment of your dishwasher or hand-washed with dish soap in hot water.
- Do NOT use solvents or abrasives.
- Rinse with hot, clean water.
- To clean the Electric Pump Main Unit, wipe it with a damp cloth, using only water or water mixed with a mild soap.

Tubing Cleaning Instructions:

- Wipe the outside of the Tubing with a clean, damp cloth. Avoid getting water or other fluids inside the Tubing.
- If liquids are found inside Tubing, rinse the Tubing with clean, hot water. Hang to AIR DRY COMPLETELY BEFORE USING. Do NOT insert any object into Tubing.

Drying Bag:

- For your convenience, you can use the included Drying Bag to hang dry all washed and sanitized accessories.

Note:

Before each use, visually inspect each individual component for cracks, chips, tears, discoloration, or deterioration, as they may affect the efficiency of the Rumble Tuff® Electric Breast Pump Duo. In the event that damage to the device is observed, please discontinue use until the parts have been replaced.

Interruption of Electrical Service

If you experience an interruption of electrical service, due to a power surge or other factors, during normal operation of your Rumble Tuff® Electric Breast Pump Duo, try the following:

- Unplug the AC/DC Adapter cord from the electrical outlet and wait for 5 seconds.
- Plug the AC/DC Adapter cord back into the electrical outlet.
- If the problem persists, try a different electrical outlet.

Radio Frequency Energy

This equipment generates, uses, and can radiate radio frequency energy. If not installed properly and used in accordance with the instructions, it may cause harmful interference with other devices in the vicinity. Try the following:

- Reorient or relocate the device receiving interference.
- Increase the distance between the equipment.
- Connect the equipment to an outlet on a different circuit from that which the other device(s) are connected.
- Consult the manufacturer or a field service technician of the device receiving interference for help.
- There is no guarantee that interference will not occur.

Decreased Suction

If it feels like the suction has decreased, try the following:

- Make sure the Breast Pump parts and accessories are assembled correctly (see Assembly Instructions pages 8-13).
- Inspect the One-Way Valve for any tears or pinholes. This component is critical to achieving proper suction. If damaged, replace the One-Way Valve with one of the spare valves that is provided with your Rumble Tuff® Electric Breast Pump.
- Detach the Tubing and Tubing Adaptor from the back of your Electric Breast Pump Duo and place a finger over the Tubing Adaptor Inlet.
- If you do feel suction, the Electric Pump Main Unit is operating properly.
- If you do NOT feel suction or feel that the suction has decreased to an unexpected strength, contact Rumble Tuff Customer Service for assistance (see Page 20).

Pump Doesn't Start

- Make sure the Adaptor is properly plugged in.
- Ensure there's enough battery power for operation.
- When battery runs low, both the Blue and White LED Lights will flash and then the pump will turn off.
- If the Pump still doesn't work, contact Rumble Tuff Customer Service for assistance (see Page 20).

Low Battery

- When the battery is low, the beeper will sound twice every two minutes.
- The pump will shut down automatically when there is not enough battery power for operation. The Swift and Natural Expression LEDS and LED Display (with "Lo" display) will flash four times, and the beeper will sound four times.

Breastmilk Buildup in the Breastshield Body

If breast milk doesn't appear to be draining fast enough into the Collection Bottle, reduce the suction setting on your Electric Breast Pump Duo to allow the milk to drain before gradually increasing.

Where to get Replacement Parts

If you are missing a part or if a part was damaged, please contact Rumble Tuff Customer Service by calling toll-free (855) 228-8388.

You can purchase additional accessories for your Rumble Tuff® Electric Breast Pump Duo by the following methods:

- Email: sales@rumbletuff.com
- Fax: (801) 796-2688
- Toll-Free: (855) 228-8388
- Online Store: www.rumbletuff.com

Note:

If it feels uncomfortable or painful on your breasts while using the Pump, try decreasing the suction level by pressing the Vacuum Adjusting Button down .

You may also try pumping with/without the Silicone Cushion.

If these tips do not help, turn the product off and remove the pump from your breasts for a few minutes. If you are still experiencing pain or discomfort, consult your healthcare professional or an international board certified lactation consultant.

Power Requirements:

- AC/DC Adapter (included) North American Plug Configuration:
Brand: Acute Ideas
Model: MLF-A00120901300U0041, 100V~240V AC, 50/60 Hz, 0.4A, wall plug type AC/DC Adaptor with DC 9V/1.33A output.
- Battery
Non-replaceable Li-Ion battery; 7.4V 850mAh Brand: Acute Ideas
Model: 18-0741000-RT00
- Position the device to ensure easy disconnection of the power cord from the supply mains.

Technical Specifications:

VACUUM:

Swift Expression: -12.0~-24kpa (-90~-180mmHg)



Natural Expression: -14.5~-35kpa (-110~-260mmHg)

Ambient Temperature range: +10OC to 40OC (50OF to 104OF)

Relative Humidity range: 20% to 80%

Transportation / Storage Environment : -10 to 50°c / 20 to 90% relative humidity

Key to Box Symbols:

-  Type BF equipment (Breastshield)
-  Consult instructions for use
-  Disposal of Electrical and Electronic Equipment (WEEE)

Made in China

Limited Consumer Product Warranty (United States)

Limited Consumer Product Warranty (United States)

This Rumble Tuff® Electric Breast Pump is warranted to the original consumer, the purchaser, to be free from defects in material and workmanship which are not commercially acceptable for a period of 120 days from the date of purchase and an extended ONE year warranty on the pump motor. This warranty applies to the original owner only. Warranty coverage terminates if you sell or otherwise transfer this product to another person. This warranty gives you specific legal rights and you may also have other rights, which vary by location.

RUMBLE TUFF MAKES NO EXPRESS WARRANTY OF ANY KIND REGARDING THIS PRODUCT OTHER THAN THOSE WARRANTIES SET FORTH HEREIN. ANY IMPLIED WARRANTY, INCLUDING ANY IMPLIED WARRANTY OF MERCHANTABILITY OR ANY IMPLIED WARRANTY OF FITNESS FOR A PARTICULAR PURPOSE TO THE EXTENT PERMITTED BY LAW, SHALL BE LIMITED IN DURATION TO A PERIOD OF 120 DAYS FROM THE DATE OF PURCHASE BY THE ORIGINAL PURCHASER.

In the event that this product is found by Rumble Tuff to not meet the above limited warranty standard, as the purchaser's sole and exclusive remedy, Rumble Tuff will repair, or, at the discretion of Rumble Tuff, replace this product without charge for such replacement parts or labor. The purchaser shall bear all expenses related to returning this product to Rumble Tuff. This warranty does not apply to any part of the product that has been subject to misuse, abuse, or alteration. Only Rumble Tuff brand replacement parts are recommended for use with Rumble Tuff breastfeeding products. Improper or incorrectly performed maintenance or repair, or use of non-Rumble Tuff brand replacement parts voids this warranty.

TO THE EXTENT PERMITTED BY LAW, RUMBLE TUFF SHALL NOT BE LIABLE FOR ANY INCIDENTAL OR CONSEQUENTIAL DAMAGES INCLUDING, BUT NOT LIMITED TO, REPLACEMENT COSTS RESULTING FROM THE BREACH OF ANY WRITTEN OR IMPLIED WARRANTY.

If you wish to make a claim under this warranty, you will need the following:

- The entire original Rumble Tuff product
- The original receipt showing date of purchase
- Return Authorization Number (RA# or RMA#)
- Detailed description of the problem

You, the purchaser, are responsible for all shipping charges.

Do NOT send product without a RA#.

To obtain an RA# and shipping address, please contact Rumble Tuff Customer Service by:

- Toll-free: 855 228-8388
- Email: customerservice@rumbletuff.com
- In writing:

Customer Service Department
Rumble Tuff
865 N 1430 W
Orem UT 84057

Items returned without an RA# will not be processed and will be returned to sender (postage due).



Rumble Tuff®

Rumble Tuff® is owned and operated by A Cute Baby, Inc.

865 N 1430 W Orem UT 84057-6402

Tel: (801) 609-8168 | Fax: (801) 796-2688

www.rumbletuff.com | www.acutebaby.com