



Rumble Tuff®

Slim-Cups

Instruction for use



EN 1 - 17

ES 18 - 35

Model: PA951

Congratulations on the purchase of your new Rumble Tuff PA951. Now you can pump hands-free at work, at home, and on the go! RumbleTuff PA951 provide many great features:

- Only 3 parts for easy assembly and cleaning.
- Easy pour.
- Closed system.
- Allows access to your pump's motor strength.



Follow our YouTube channel for pumping tips and how-to videos

1. Introduction	1
2. Important Information	3
3. Product Description	4
4. Start-up Procedure and Operation	
4.1 Cleaning	5
4.2 Assembly	8
4.3 Placement In Bra	10
4.4 Correct Breast Shield Fit	11
4.5 Positions For Expressing.....	12
4.6 Disconnecting Collection Cups And Milk Transfer	12
4.7 Cup Test And Trim Tubing.....	13
5. Breast Milk Storage and Thawing	14
6. Connecting to Breast Pump	15

- DO NOT boil tubing or adapters. Contains small parts, which may be a choking hazard for children.
- Rumble Tuff PA951 are a personal care item and intended for use by only one person.
- This device is intended for use with any Rumble Tuff electric breast pump. Using it with another breast pump brand is solely at the user's discretion.
- If you experience pain or have lactation-related questions while using this device, seek professional advice from a lactation consultant to ensure you are using Rumble Tuff PA951 properly.

As a Rumble Tuff user, you automatically qualify for free pumping consults from an IBCLC.

Schedule your appointment on-line:

<https://www.rumbletuff.com/lactation-consultants>

3. Product Description

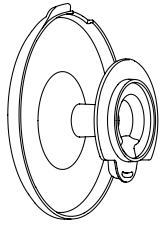

2X 21&19mm
Breast Shield /
Flange



2X Diaphragm

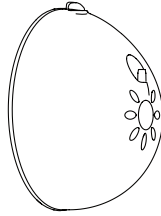

2x Cup

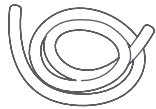

2x Tubing

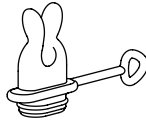

2X Plug



1x Brush



1x Drying Bag

Note: For ordering information about accessories, please visit www.rumbletuff.com/accessories; or contact our customer service. Toll-Free: (855) 228-8388

4. Start-up Procedure and Operation

4.1 Cleaning

Sanitize Prior to First Use:

Before first use, disassemble and boil all parts of the PA951 in water for 10 minutes.



- Be sure to use enough water to keep all parts afloat while boiling.
- **Do NOT boil Tubing or Tubing Adapter.**
- Use tongs to remove all parts from water immediately after sterilizing. To avoid scalds and burns, do NOT touch the product with bare hands right after sterilizing.
- Completely air-dry. Wet components may affect the performance of your Pump. Please ensure that all parts are completely dry before use.

Before Each Use:

1. **Wash hands.** Wash your hands well with soap and water.
2. **Assemble.** Assemble the clean PA951 parts. Inspect each component for any cracks, tears, discoloration, or deterioration. If damage is found, please discontinue use and replace the part immediately. Inspect the PA951 parts or tubing to see if they have become moldy or soiled during storage. If your tubing is moldy, discard and replace immediately.

After Every Use:

1. **Store milk safely.** Store in refrigerator or freezer immediately.
2. **Disassemble and inspect PA951.** Remove the tubing and set it aside. Separate all the parts that come into contact with breast/breast milk.
3. **Rinse PA951.** To remove any milk residue, rinse the PA951 parts that come into contact with breast/breast milk under running water.

4. **Clean PA951.** PA951 are hand washable or dishwasher safe:

- **Rinse and wash by hand (before first use and after each use)**

1. **Use a wash basin.** Place PA951 parts in a clean wash basin used only for washing infant feeding equipment. Do not place pump parts directly in the sink because germs in sinks or drains could contaminate the PA951 parts.
2. **Add soap and water.** Fill wash basin with hot water and add soap.
3. **Scrub.** Scrub items using a clean brush that is used only to clean infant feeding items.

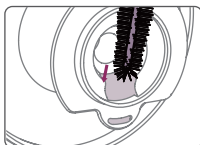

Note:
Scrub the tunnel with the brush to avoid milk residue

4. **Rinse.** Rinse by holding items under running water, or by submerging in fresh water in a separate basin that is used only for cleaning infant feeding items.
5. **Dry.** Allow to air-dry thoroughly. Place PA951 parts, wash basin, and bottle brush on a clean, unused dish towel or paper towel in an area protected from dirt and dust. Do not use a dish towel to rub or pat items dry because doing so may transfer germs to the items. Rumble Tuff also provides a Drying Mesh Bag for your convenience.

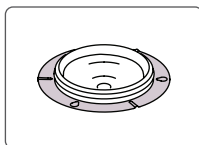
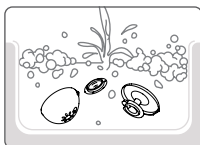

Caution:
When storing the Diaphragm, be careful not to squeeze or deform the Valve.

- **Wash in dishwasher (maximum once per day)**

1. Place the disassembled parts, except for the tubing, on the top rack or in the cutlery section.
2. Allow to completely dry after washing.

Note:

If using a dishwasher, parts may become discolored. This will not impact the functioning of the parts.

5. **Sanitize PA951 once per day after use.** Sanitize the parts according to P.9

6. **Tubing**

- Wipe the outside of the Tubing with a clean, damp cloth. Avoid getting water or other fluids inside the Tubing.
- If liquid is found inside the Tubing, rinse the Tubing with clean, hot water. Hang to AIR DRY COMPLETELY BEFORE USING. Do NOT insert any object into Tubing.

Store Safely Until Needed

Store pump and all parts in a safe dry area.

- **Wash hands.** Wash hands well with soap and water.
- **Reassemble.** Put together the clean, dry PA951 parts.
- **Store safely.** Place reassembled PA951 in a clean, protected area.

Tubing Cleaning Instructions:

- Rumble Tuff breast pump tubing is designed not to touch the pumped milk and does not need to be cleaned routinely.
- If the tubing has water droplets in it, disconnect it from the PA951, and inspect the diaphragm for damage.
- Discard the Tubing if any mold is present. Replace immediately.
- If the outside of your tubing is soiled, wipe it with a low-level disinfectant such as Ethyl or Isopropyl Alcohol (70 – 90 %).
- Do not insert any object into the Tubing.

4.2 Assembly

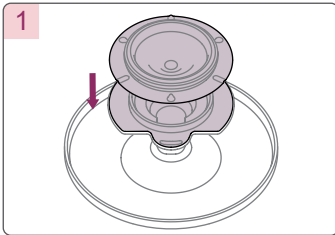

Align the waterdrop mark with the outlet. Place diaphragm on top of breast shield and press around edge of diaphragm completely for secure fit.

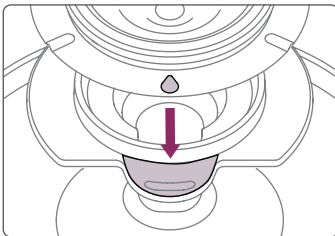

Confirm Breast Shield base is properly aligned with cup.

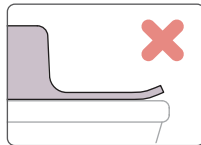
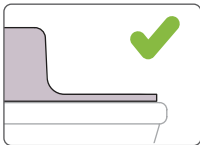

Note:
Ensure that the stem is snug against the Valve opening.

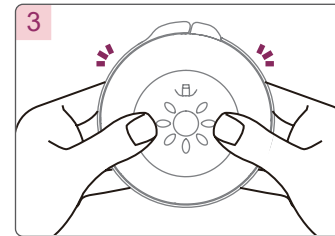
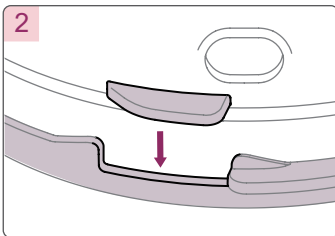

Put the Cup and the Breast Shield together and press around edges of breast shield to ensure trim is snug against cup.

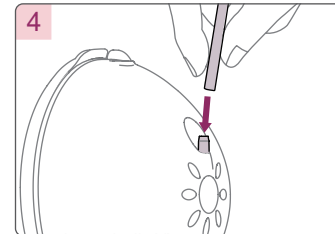

Connect the Tubing to the Tubing Connector located on the Cap.

Note:
Make sure there is no moisture in the Tubing

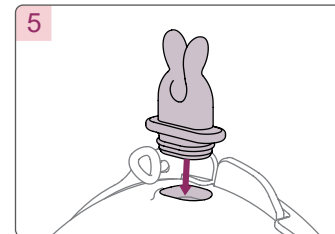

Insert the plug into the outlet to prevent milk from splashing during movement.

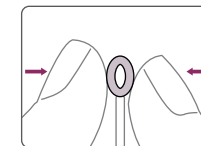
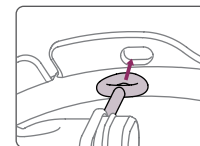

Note:
Prevent from losing the plug by locking it on the breast shield

4.3 Placement In Bra

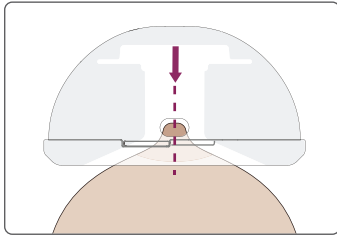

Center nipple in flange and make sure there is a complete seal between the flange and skin.

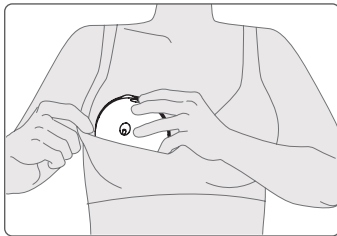
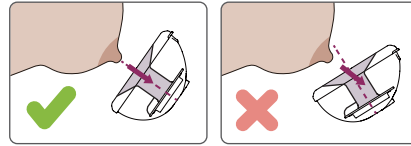

The PA951 can be worn under your regular nursing bra. Your bra will hold the collection cup in place. If you find it uncomfortable or painful during use, try switching to a looser, more stretchy nursing bra.

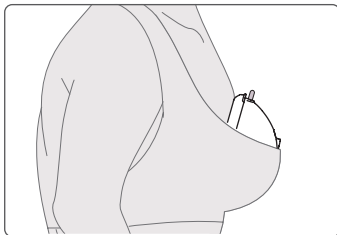

Close bra and ensure no slipping, sagging, or tilting. You can fix the plug on the breast shield to prevent from losing it.

Note:
Insecure fit may cause loss of suction.

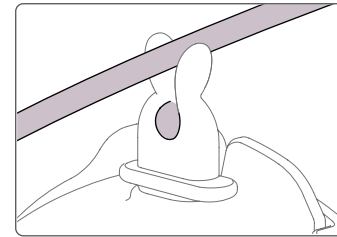

Use the notch on the top of the peak to fix the tubing, then let the tubing follow the side of the cup inside the bra.

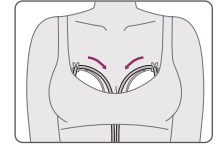

4.4 Correct Breast Shield Fit

- Measure nipples before pumping session.
- Please refer to rumbletuff.com/size-matters-quick-flange-breast-shield-guide/ for breast shield/flange size guidance.

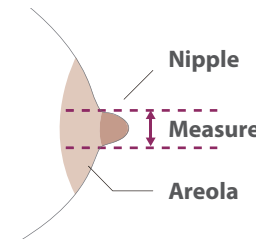

The Slim-Dups come with 21&19mm breast shield/ flange size. Optional 15mm, 17mm, and 24mm breast shield/ flange are available for purchase at rumbletuff.com.

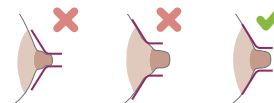

too small too large correct fit

To allow for proper fit, breast shield / flange should be about 1 - 3mm larger than nipple diameter.

- Please refer rumbletuff.com/how-to-measure-your-nipples-for-the-proper-flange-fit-size/ options.



4.5 Positions For Expressing

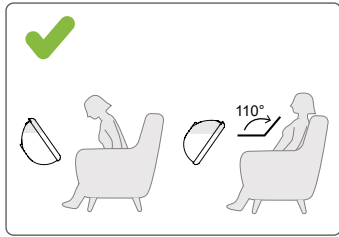

Good position

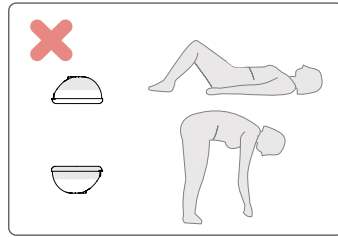

Poor position

4.6 Disconnecting Collection Cups And Milk Transfer

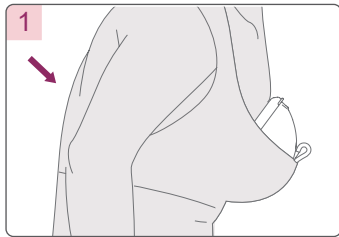

1 To avoid milk spilling out of the tunnel, keep the pump running & slightly lean forward to ensure all milk from the breast shield tunnel enters the collection cups.

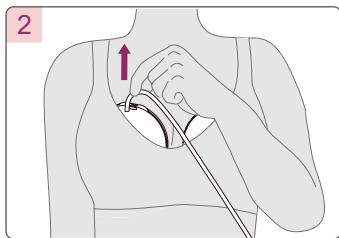

2 To detach the Tubing from the Cup.

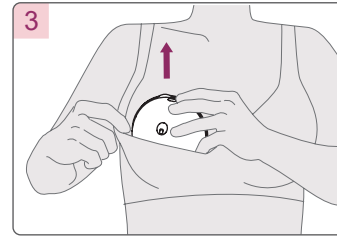

3 Carefully remove the Cup from the bra and place it on a firm and flat surface.

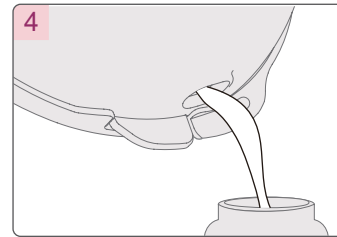
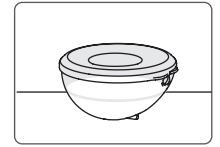

4 Open the spout cover and pour the breast milk into a Rumble Tuff Milk Bag or bottle.

Note:
If the milk pouring is not smooth, please tilt the Cup to pour milk

4. Start-up Procedure and Operation

4.7 Cup Test And Trim Tubing

Prior to placing Hands-Free Collection Cups in bra:

1. Connect and turn pump on.
2. Adjust suction to highest comfortable setting.
3. Observe diaphragm movement. The diaphragm will move up and down during operation when you have assembled the cups correctly.

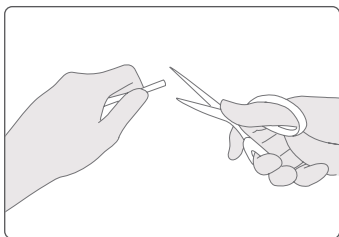
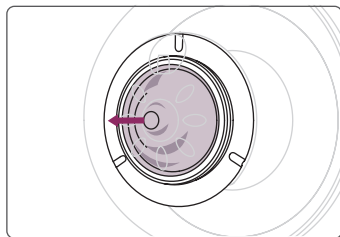
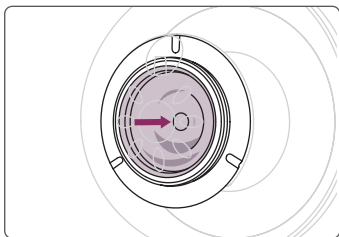

Tubing can be trimmed to desired length.

5. Breast Milk Storage and Thawing

Storage Location and Temperatures

TYPE OF BREAST MILK	Countertop 77°F (25°C) or colder (room temperature)	Refrigerator 40°F (4°C)	Freezer 0°F (-18°C) or colder
Freshly Expressed or Pumped	Up to 4 Hours	Up to 4 Days	Within 6 months is best Up to 12 months is acceptable
Thawed, Previously Frozen	1–2 Hours	Up to 1 Day (24 hours)	NEVER refreeze human milk after it has been thawed
Leftover from a Feeding (baby did not finish the bottle)	Use within 2 hours after the baby is finished feeding		



Source: CDC - Human Milk Storage Guidelines
(https://www.cdc.gov/breastfeeding/recommendations/handling_breastmilk.htm)

Note:

1. Always make sure to check the date on the milk's container before using. Do not use undated milk, or milk that has been stored too long.
2. Thaw frozen milk in the refrigerator or under cool, running water.
3. Heat the milk under warm, running water and gently swirl the container to mix the milk.
4. If warm water is not available, heat a pan of water on the stove. Once the water is warm, not boiling, remove the pan from the stove and place milk container in the pan. Never warm the milk container directly on the stove.
5. Never microwave breast milk because microwaves can cause dangerous hot spots that could burn you or your baby.
6. Always test the temperature of the milk on the inside of your wrist before feeding it to a baby. The milk should feel warm, not hot.
7. After thawing, milk should be stored in the refrigerator for no more than 24 hours.
8. Never refreeze thawed milk. Throw away previously frozen milk that is not used within 24 hours.

6. Connecting to RT Breast Pump

- Insert ribbed end of connector into tubing.
- Insert smooth end of connector into the opening directly above diaphragm.

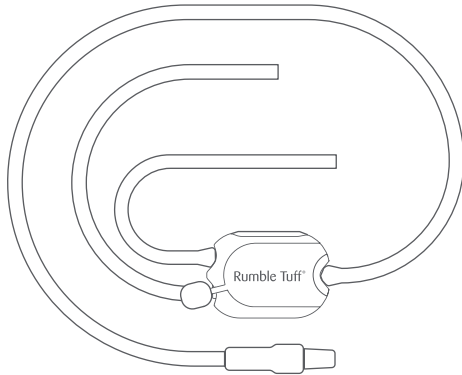
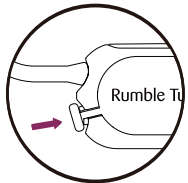
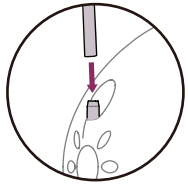

For single pumping

Rumble Tuff® Breast Pump



• EZ Express

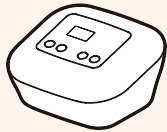

• Whisper

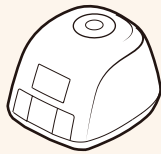

• Breeze

Note:

Desired suction level may vary from standard collection combo kits.

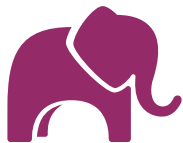

Rumble Tuff®

865 N 1430 W Orem UT 84057-6402

Tel: (801) 609-8168 Fax: (801) 796-2688

www.rumbletuff.com